



# Hannay Reels®

*The reel leader.*

**mdi is your Hannay Distributor**

**call: (727) 835 - 0674 | fax: (813) 571 - 0422**

**www.HannayReelSales.com | sales@HannayReelSales.com**

## ISO 185

### PARTS LIST Series TWCR

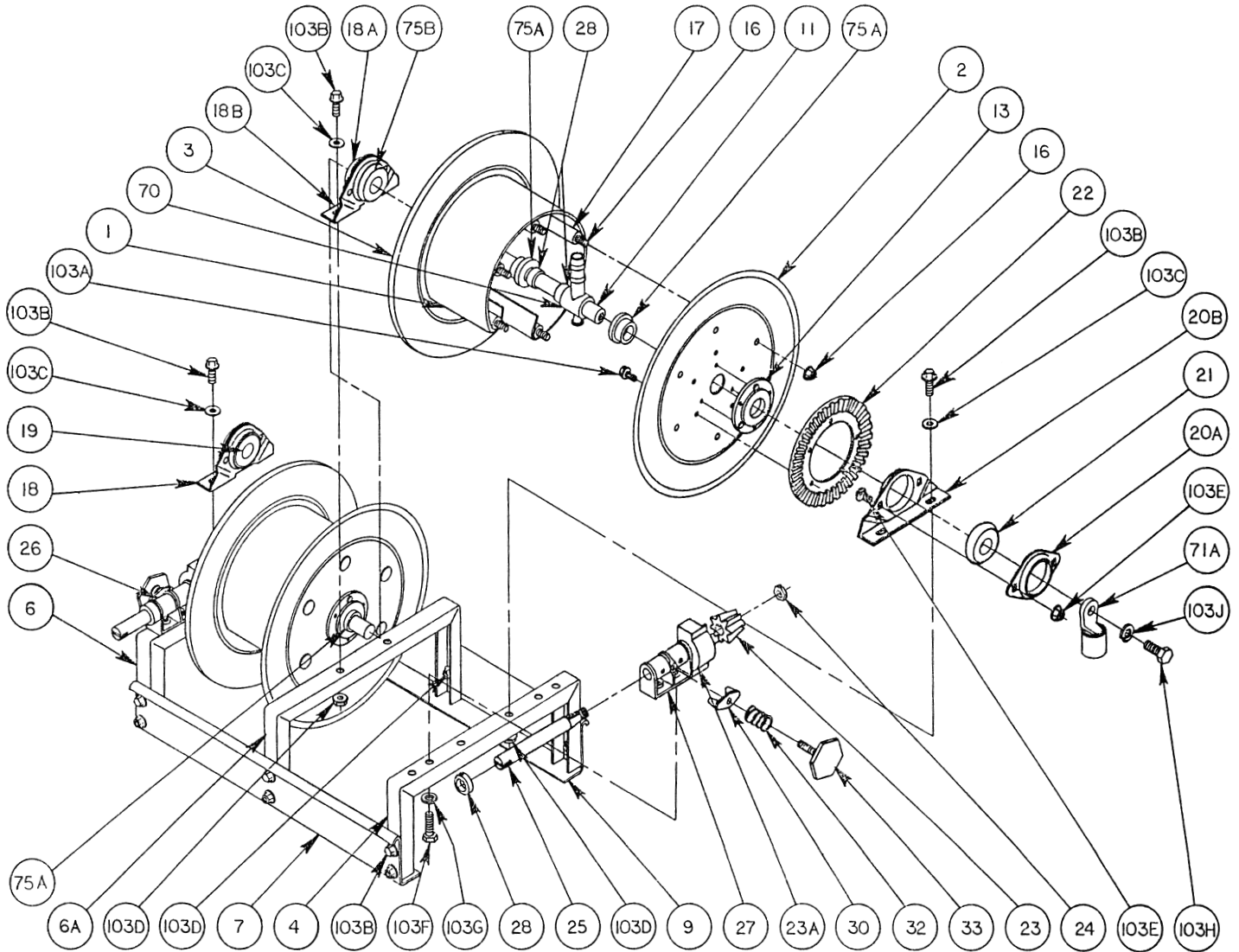

**PARTS LIST**  
**ISO 185**  
**Series TWCR**

When ordering parts  
**BE SURE TO SPECIFY COMPLETE MODEL NUMBER and SERIAL NUMBER OF REEL.**  
**USE PART NUMBER!**

<u>Drawing No.</u>	<u>Description</u>	<u>PART NUMBER</u>	<u>Quantity</u>
1	Drum, 10-1/2" Dia. - Wrap-around .....(Specify Model)	9905.0138	2
2	Front Disc, 16-1/2" Dia. (17-18).....(Specify Model)	9903.0516	2
2	Front Disc, 18-3/4" Dia. (19-20).....(Specify Model)	9903.0821	2
3	Back Disc, 16-1/2" Dia. (17-18).....(Specify Model)	9903.0516	2
3	Back Disc, 18-3/4" Dia. (19-20).....(Specify Model)	9903.0821	2
4	Front Frame, 1-1/2" Rollform Channel (17-18).....(Specify Model)	9906.0061	1
4	Front Frame, 1-1/2" Rollform Channel (19-20).....(Specify Model)	9906.0081	1
6	Back Frame, 1-1/2" Rollform Channel (17-18).....(Specify Model)	9906.0061	1
6	Back Frame, 1-1/2" Rollform Channel (19-20).....(Specify Model)	9906.0081	1
6A	Center Frame, 1-1/2" Rollform Channel (17-18).....(Specify Model)	9906.0061	1
6A	Center Frame, 1-1/2" Rollform Channel (19-20).....(Specify Model)	9906.0081	1
7	Front Foot, 2" x 4" .....	Specify Model	1
9	Back Foot, 2" x 4" .....	Specify Model	1
11	Hub, 1" O.D. Brass, P32A-00090 .....(Specify Model)	9955.0060	2
13	Disc Washer, EH-936 .....	9965.0015	4
16	3/8"-16 Carriage Bolt w/ Nut .....	Specify Model	12
17	3/8" Spacer Pipe .....	Specify Model	12
18	1" I.D. Delrin Self-Aligning Complete (Back) .....	9902.1401	1
18A	Self-Aligning Bearing Holder (Center).....	9902.2800	1
18B	Self-Aligning Bearing Pillowblock (Center).....	9902.2900	1
19	1" I.D. Delrin Bearing Insert Only (Back), P02A-00030.....	9902.1501	1
20A	Self-Aligning Bearing Holder (Front) .....	9902.2800	1
20B	Self-Aligning Bearing Pillowblock (Front) .....	9902.2900	1
21	1" I.D. Delrin Bearing Insert Only (Front), P02A-00030 .....	9902.1501	1
22	Ring Gear, H-26 .....	9914.0372	2
23	Pinion Gear, H-27.....	9914.0393	2
23A	Gear Guard .....	9914.0618	2
24	5/8"-16 SAE Hex Head Nut (ESNA).....	9904.5600	2
25	Pinion Shaft, PS-8.....	9914.0250	2
26	Manual Crank Rewind Assembly Complete.....	9914.0200	1
27	Pinion Shaft Bearing, H-2A.....	9914.0243	2
28	Pinion Shaft Collar w/ Set Screw PSC-1.....	9914.0351	6
30	Brake Pad, H-3.....	9914.0433	2
32	Brake Spring, H-31.....	9914.0451	2
33	Brake Wheel, H-30A.....	9914.0413	2
70	Single Conductor, 400 Amp, Roto-Ground Head.....	9942.0172	2
71A	Offset Connector, #2-OF .....	9955.0025	2
75A	Insulating Collar - P28A-00160 .....	9955.0198	2
75B	1" I.D. Delrin Bearing Insert Only (Center), P02A-00050.....	9902.1502	1
103A	5/16"-18 x 1/2" Spinlock Bolt.....	9904.2158	10
103B	3/8"-16 x 3/4" Spinlock Bolt.....	9904.2201	18
103C	3/8" Flat Washer .....	9954.0007	6
103D	3/8"-16 Spinlock Nut.....	9904.6200	18
103E	3/4"-16 x 3/4" Carriage Bolt w/ Nut .....	9904.0201	6
103F	1/2"-13 x 1" Hex Head Bolt .....	9904.1402	4
103G	1/2" Lock Washer .....	9954.0030	4
103H	1/2"-13 x 1" Hex Head Bolt (Silicon Bronze).....	9955.0222	2
103J	1/2" Lock Washer (Silicon Bronze).....	9955.0221	2